

AW-D112 is an intelligent addressable control module, which can be configured with Asenware AW-FP100 Series Addressable Fire Alarm Control Panel.

Each point (device) can be given specific ID or individual address, which allows the panel to give a voltage output signal(24VDC) to control FPE or any other devices.

AW-D112 control modules provides a notification circuit to activate the notification devices i.e. horn, strobes etc.

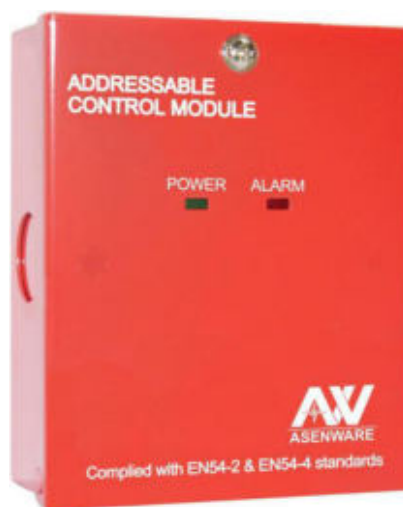

Features

- ✓ Addressable-analog communication
- ✓ Two-wire connection
- ✓ Two LEDs one is Green, which blinks in normal condition and another one is Red which becomes steady during fire alarm condition
- ✓ Remote test from Panel

Installation

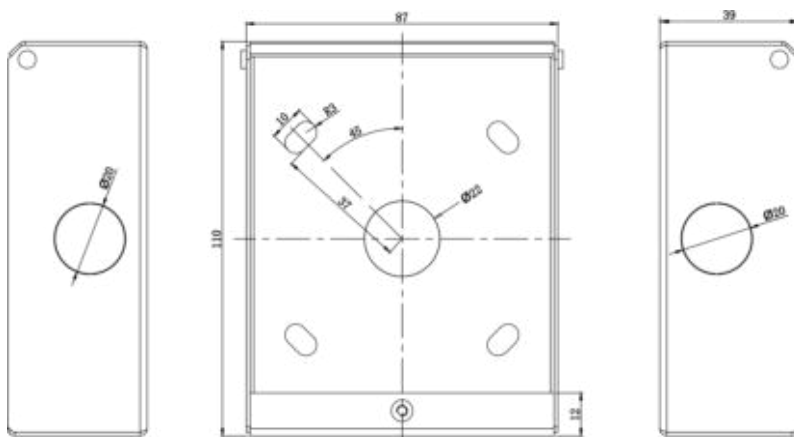

Technical Specification

Model	AW-D112
Operating voltage	18~28VDC @Loop
Operating current(@Loop 24VDC)	Standby status≤5mA

Wiring	The promise of two bus system(Loop in, Loop out)
Protection level	IP 30
Load capacity	≤200mA @Loop 24VDC
Environmental	Temperature range: -10~50°C (14~122°F) Humidity: 5 to 95% RH, non-condensing
Mating host	AW-FP100 series fire alarm control panel
Size (L*W*H)	110mm* 87mm* 39mm
Weight	About 315g

